

AERODROME CHART - ICAO

38°04'44"N
007°55'57"W

ELEV 194 m

TWR	130.400	241.000
APP	130.100	278.000
SMC	120.700	234.000

BEJA / LPBJ

ELEVATIONS AND DIMENSIONS IN METRES
BEARINGS ARE MAGNETIC

VAR 08° W 2010
ANNUAL CHANGE 09" E

RWY	DIRECTION	THR	BEARING STRENGTH
01L	009°	38°03'48"N 007°56'04"W	PCN 44/R/B/W/T
19R	189°	38°05'40"N 007°55'49"W	
01R	009°	38°03'56"N 007°55'54"W	PCN 45/R/B/W/T
19L	189°	38°05'31"N 007°55'42"W	

TWY	WIDTH	SURFACE	BEARING STRENGTH
A1	30 m	CONC	PCN 68/R/C/W/T
B1			PCN 77/R/C/W/T
E1			PCN 83/R/C/W/T
G1			PCN 95/R/C/W/T
D	15 m	CONC	PCN 67/R/C/W/T
A2, B2, B3, C, E2, F1, F2, G2, G3			PCN 55/R/B/W/U
H			PCN 26/F/D/W/U
J	23 m	ASPH	PCN 139/F/B/W/T

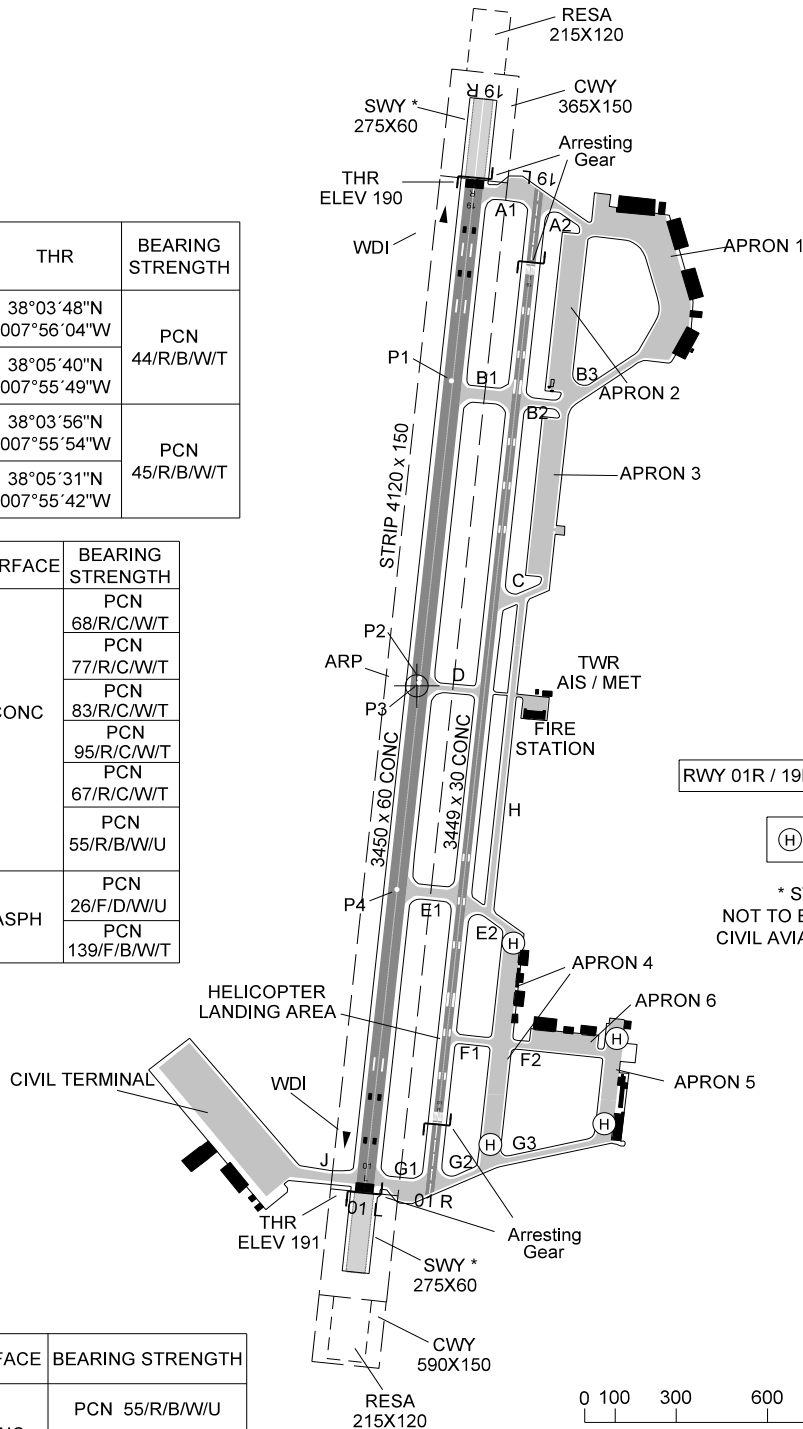

RWY 01R / 19L AVBL ONLY FOR TAXI

(H) ACFT based

* SWY 01L / 19R
NOT TO BE CONSIDERED IN
CIVIL AVIATION OPERATIONS

APRON	SURFACE	BEARING STRENGTH
1/2/3	CONC	PCN 55/R/B/W/U
4/5/6		PCN 41/R/B/W/U
CIVIL TERMINAL	N/A	N/A

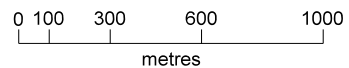

Arresting gear information updated.