

AERODROME GROUND
MOVEMENT CHART - ICAO

APRON ELEV
101 m

LISBOA ARR INFORMATION 124.155
LISBOA DEP INFORMATION 121.955

LISBOA DELIVERY 118.955
LISBOA GROUND 121.755
LISBOA TOWER 118.105

LISBOA, Humberto Delgado (LPPT)

TAXI ROUTE PROCEDURES ARRIVAL / DEPARTURE RWY 02

VAR 02° W 2020
ANNUAL CHANGE 10' E

HOTSPOT



ARRIVAL RWY 02
 - Pilots should plan their landing to vacate RWY 02 via TWY "H4", in order to minimize runway occupancy time, except by agreement of ATC.
 - If, for any particular reason, you wish to vacate via taxiway "A6" or "T5", make the request on first contact with TWR.

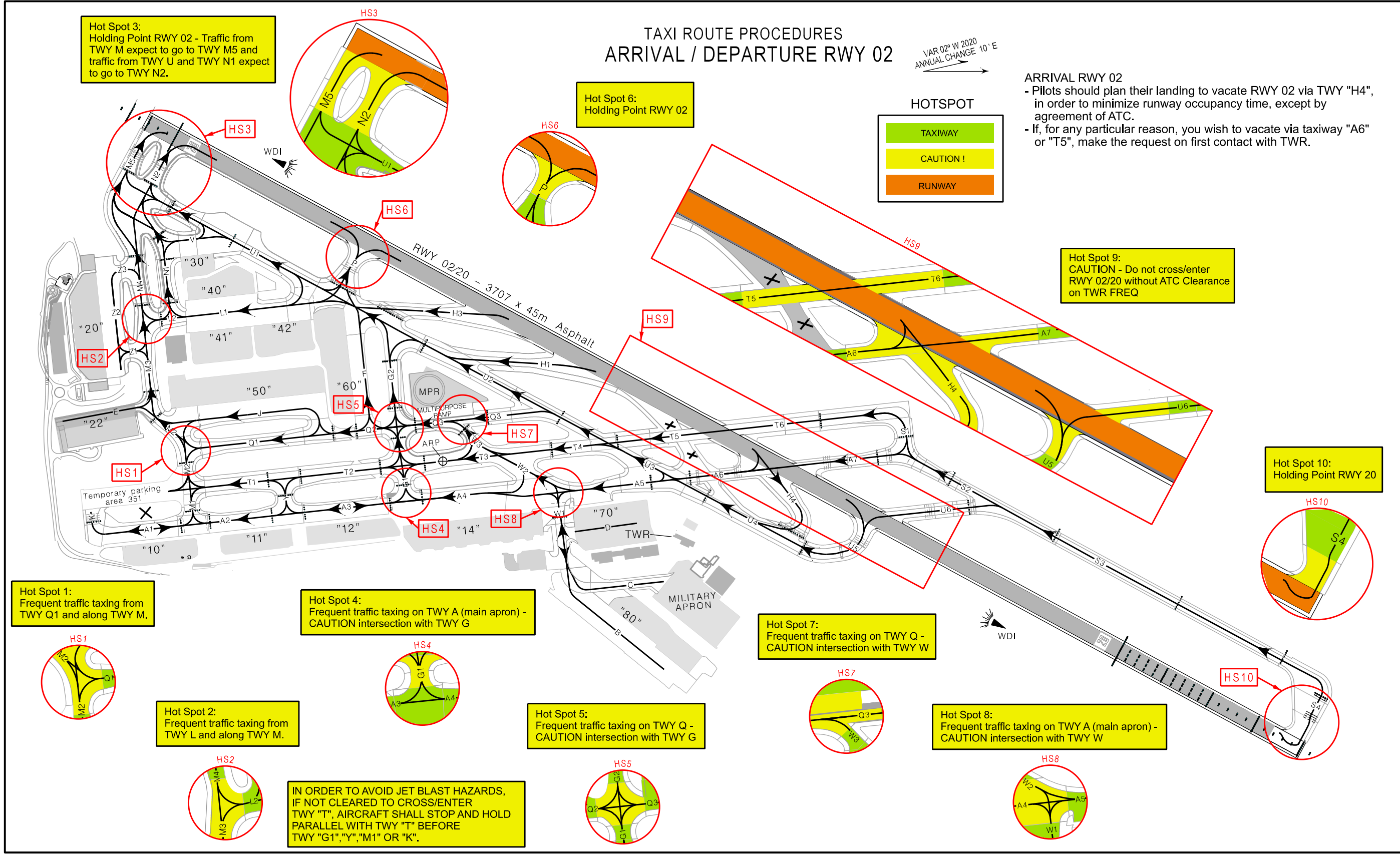

Hot Spot 3:
 Holding Point RWY 02 - Traffic from TWY M expect to go to TWY M5 and traffic from TWY U and TWY N1 expect to go to TWY N2.

Hot Spot 6:
 Holding Point RWY 02

Hot Spot 9:
 CAUTION - Do not cross/enter RWY 02/20 without ATC Clearance on TWR FREQ

Hot Spot 10:
 Holding Point RWY 20

Hot Spot 1:
 Frequent traffic taxiing from TWY Q1 and along TWY M.

Hot Spot 4:
 Frequent traffic taxiing on TWY A (main apron) - CAUTION intersection with TWY G

Hot Spot 7:
 Frequent traffic taxiing on TWY Q - CAUTION intersection with TWY W

Hot Spot 2:
 Frequent traffic taxiing from TWY L and along TWY M.

Hot Spot 5:
 Frequent traffic taxiing on TWY Q - CAUTION intersection with TWY G

Hot Spot 8:
 Frequent traffic taxiing on TWY A (main apron) - CAUTION intersection with TWY W

IN ORDER TO AVOID JET BLAST HAZARDS, IF NOT CLEARED TO CROSS/ENTER TWY "T", AIRCRAFT SHALL STOP AND HOLD PARALLEL WITH TWY "T" BEFORE TWY "G1", "Y", "M1" OR "K".

MAG VAR changed. New RWY designator.

THIS PAGE INTENTIONALLY LEFT BLANK