

AERODROME GROUND MOVEMENT CHART - ICAO

APRON ELEV 101 m

LISBOA ARR INFORMATION 124.155  
LISBOA DEP INFORMATION 121.955

LISBOA DELIVERY 118.955  
LISBOA GROUND 121.755  
LISBOA TOWER 118.105

LISBOA, Humberto Delgado (LPPT)

TAXI ROUTE PROCEDURES ARRIVAL / DEPARTURE RWY 20

VAR 02° W 2020  
ANNUAL CHANGE 10' E

HOTSPOT



ARRIVAL RWY 20

- Pilots should plan their landing to vacate RWY 20 via TWY "H3", in order to minimize runway occupancy time, except by agreement of ATC.
- If, for any particular reason, you wish to vacate via taxiway "A6" or "T5", make the request on first contact with TWR.

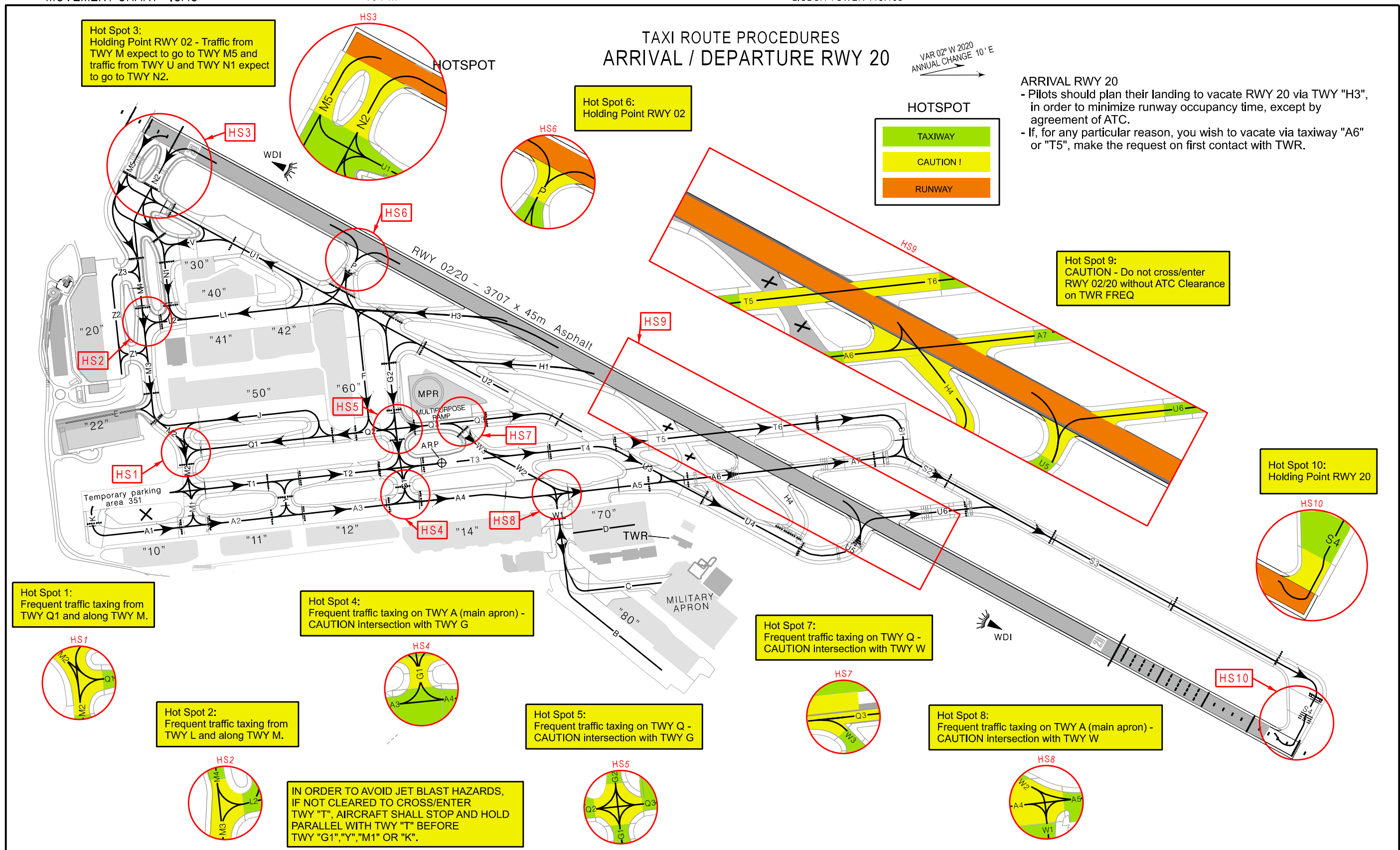

MAG VAR changed. New RWY designator.

THIS PAGE INTENTIONALLY LEFT BLANK